

PLANETARY MIXER AEROMIX 7.5

Date	_____
Project	_____
Location	_____

MODEL	ITEM CODE



Models:

- AEROMIX 7.5



General technical characteristics:

- Electronic variator (inverter) to 6 speeds;
- Structure in high thickness steel sheet;
- Standard equipment: spiral, blade, whisk, scraper and contrast rod;
- Removable stainless steel grid for cleaning;
- CE and EAC certification.

Optional accessories:

- Special tension;
- Stainless steel version.

Warranty:

- One year, ☒



Technical Data

Dimensions

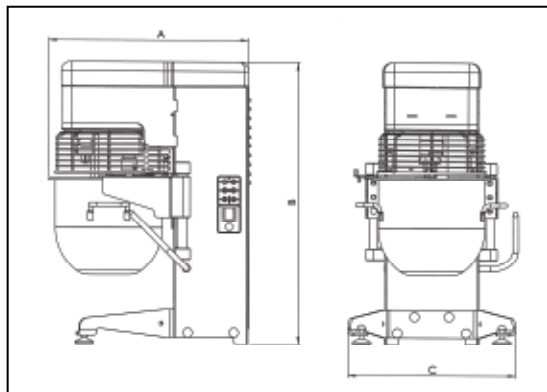

MODEL	A	B	C	Power [kW]	Bowl [liter]	Bowl x H [mm]
AEROMIX 7.5	440 (17")	613 (24")	365 (14")	0.25	7.5	230x210 (9"x8")

Voltage: 220V/1/60Hz
(*Optional:* special voltages)

Transmission belts.

Protections: safety grid.

Control panel: choosing the speed through the pulsed (1-6) the machine part. To increase/decrease the speed is pressed simultaneously (1-2/3-4) and to stop press the button 5-6.

Speeds: Planetary rpm 35-150; Spiral; Tool rpm ratio i=2.7.

Shipping information

Model	Net weight	Gross weight	
		Pallet	Cage
AEROMIX 7.5	40kg (80lb)	50kg (110lb)	90kg (198lb)

Information on the packaging

MODEL	Box on pallet		Cage/Crate	
	Dimensions [mm]	Volume [m ³]	Dimensions [mm]	Volume [m ³]
AEROMIX 7.5	630x410x770 (25"x16"x30")	0.2 (7ft ³)	700x530x780 (27"x21"x30")	0.29 (10.44ft ³)





AEROMIX 10-20

AEROMIX 20H-30

AEROMIX 40

Models:

- AEROMIX 10
- AEROMIX 20
- AEROMIX 20H
- AEROMIX 30
- AEROMIX 40



General technical characteristics:

- Belts speed variator 7 speeds;
- Motorized bowl lifting (for AEROMIX 40);
- High and constant torque at all speeds;
- Manual operation or with timer;
- Standard equipment: spiral, blade, whisk, scraper and contrast rod;
- Removable stainless steel grid for cleaning;
- CE and EAC certification.

Optional accessories:

- Special tension;
- Drain bowl cap;
- Smaller bowls and tools available;
- Stainless steel tools Kit;
- Heating bowl system;
- Reducer;
- Stainless steel version.

Warranty:

- One year, ☒



Technical Data

Dimensions

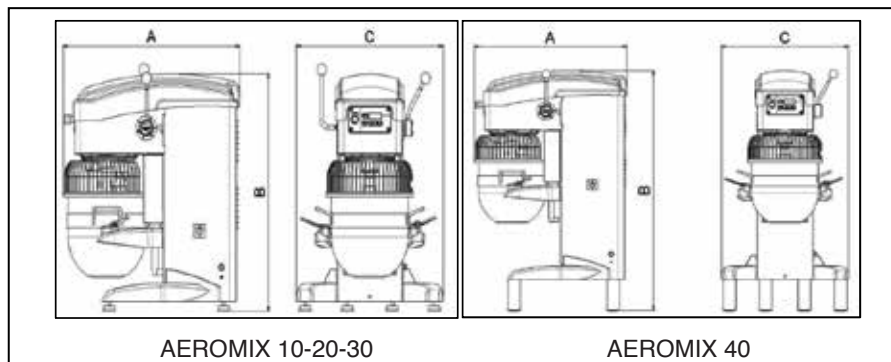

MODEL	A	B	C	Power [kW]	Bowl [liter]	Bowl x H [mm]
AEROMIX 10	600 (23")	775 (30")	560 (22")	0.5	10	250x230 (10"x9")
AEROMIX 20	725 (28")	840 (33")	605 (24")	0.9	20	315x290 (12"x11")
AEROMIX 20H	725 (28")	1180 (46")	605 (24")	0.9	20	315x290 (12"x11")
AEROMIX 30	735 (29")	1180 (46")	605 (24")	1.1	30	350x365 (14"x15")
AEROMIX 40	910 (36")	1355 (53")	700 (27")	1.5	40	400x370 (16"x14")

Voltage: 400V/3/60Hz
(*Optional:* special voltages)

Transmission belts.

Protections: emergency button and safety grid.

Control panel: set the timer and press the START button. To stop the machine wait that the timer ends its strokes, or press the STOP button. The variation of the speed is done manually.

Speeds: Planetary rpm 35-150; Spiral; Tool rpm ratio i=2,7.

Shipping information

Model	Net weight	Gross weight	
		Pallet	Cage
AEROMIX 10	120kg (264lb)	130kg (286lb)	170kg (374lb)
AEROMIX 20	130kg (286lb)	140kg (308lb)	180kg (396lb)
AEROMIX 20H	135kg (297lb)	145kg (319lb)	185kg (407lb)
AEROMIX 30	140kg (308lb)	150kg (330lb)	190kg (418lb)
AEROMIX 40	215kg (473lb)	225kg (496lb)	265kg (584lb)

Information on the packaging

MODEL	Box on pallet		Cage/Crate	
	Dimensions [mm]	Volume [m ³]	Dimensions [mm]	Volume [m ³]
AEROMIX 10	750x700x1100 (29"x27"x43")	0.58 (20.5ft ³)	980x830x1160 (38"x32"x46")	0.94 (33.2ft ³)
AEROMIX 20	750x700x1100 (29"x27"x43")	0.58 (20.5ft ³)	980x830x1160 (38"x32"x46")	0.94 (33.2ft ³)
AEROMIX 20H	750x700x1500 (29"x27"x59")	0.79 (27.9ft ³)	980x830x1500 (38"x32"x59")	0.95 (33.5ft ³)
AEROMIX 30	750x700x1500 (29"x27"x59")	0.79 (27.9ft ³)	980x830x1500 (38"x32"x59")	0.95 (33.5ft ³)
AEROMIX 40	940x650x1600 (37"x25"x63")	0.98 (34.6ft ³)	1060x900x1550 (42"x35"x61")	1.48 (52.26ft ³)





Models:

- AEROMIX 60
- AEROMIX 80
- AEROMIX 100



General technical characteristics:

- Motorized bowl lifting;
- High torque at low speed;
- Total release of the tool;
- Timer, revolution counter and thermometer with head probe;
- Bowl on wheels;
- Programmable control panel with 5 speeds and pause;
- Standard equipment: spiral, blade, whisk, scraper and contrast rod;
- Removable stainless steel grid for cleaning;
- CE and EAC certification.

Optional accessories:

- Special tension;
- Drain bowl cap;
- Air pressure incoming system;
- Bowl lighting;
- Water nebulisation system;
- PLC control panel;
- Stainless steel version.

Warranty:

- One year, ☉



Technical Data

Dimensions

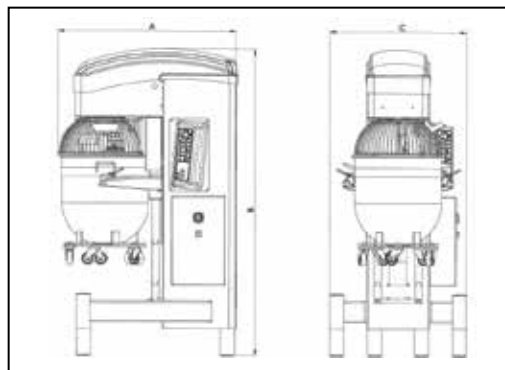

MODEL	A	B	C	Power [kW]	Bowl [liter]	Bowl x H [mm]
AEROMIX 60	1000 (39")	1750 (69")	800 (31")	2.2	60	450x370 (18"x14")
AEROMIX 80	1015 (39.5")	1954 (77")	800 (31")	4.0	80	480x506 (19"x20")
AEROMIX 100	1029 (40")	1954 (77")	800 (31")	4.0	100	510x600 (20"x24")

Voltage: 400V/3/60Hz
(*Optional:* special voltages)

Transmission belts.

Protections: emergency button and safety grid.

Control panel: or you can work in manual or automatic .

Manual : you set the time and speed and hit the START button. To stop the machine expects that the timer runs out or you press the STOP button.
Automatic: you choose the program saved and press the START button. To stop the machine expects the program to finish or you press the STOP button.

Speeds: Planetary rpm 35-150; Spiral; Tool rpm ratio i=2,7.

Shipping information

Model	Net weight	Gross weight	
		Pallet	Cage
AEROMIX 60	1000 (39")	1750 (69")	800 (31")
AEROMIX 80	980 (38")	-	766 (30")
AEROMIX 100	1029 (39.5")	-	766 (30")

Information on the packaging

MODEL	Box on pallet		Cage/Crate	
	Dimensions [mm]	Volume [m ³]	Dimensions [mm]	Volume [m ³]
AEROMIX 60	1100x870x1770 (43"x34"x70")	1.7 (60.0ft ³)	1130x980x2110 (44"x38"x83")	2.34 (82.64ft ³)
AEROMIX 80	-	-	1130x980x2110 (44"x38"x83")	2.34 (82.64ft ³)
AEROMIX 100	-	-	1380x1280x2380 (54"x50"x93")	4.20 (148.3ft ³)





Models:

- AEROMIX 120
- AEROMIX 160



General technical characteristics:

- Motorized bowl lifting;
- High torque at low speed;
- Total release of the tool;
- Timer, revolution counter and thermometer with head probe;
- Bowl on wheels;
- Programmable control panel with 5 speeds and pause;
- Standard equipment: spiral, blade, whisk, scraper and contrast rod;
- Removable stainless steel grid for cleaning;
- CE and EAC certification.

Optional accessories:

- Special tension;
- Drain bowl cap;
- Air pressure incoming system;
- Bowl lighting;
- Water nebulisation system;
- PLC control panel;
- Stainless steel version.

Warranty:

- One year, ☒



Technical Data

Dimensions

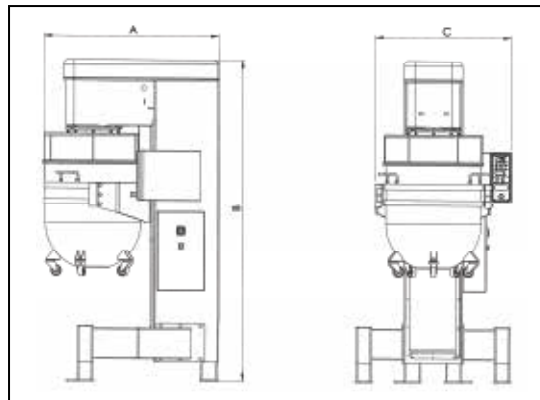

MODEL	A	B	C	Power [kW]	Bowl [liter]	Bowl x H [mm]
AEROMIX 120	1115 (44")	2045 (80")	980 (38")	4.0	120	550x600 (22"x26")
AEROMIX 160	1250 (49")	2045 (80")	980 (38")	5.5	160	600x600 (26"x26")

Voltage: 400V/3/60Hz
(*Optional:* special voltages)

Transmission belts.

Protections: emergency button and safety grid.

Control panel: or you can work in manual or automatic .

Manual : you set the time and speed and hit the START button. To stop the machine expects that the timer runs out or you press the STOP button.

Automatic: you choose the program saved and press the START button. To stop the machine expects the program to finish or you press the STOP button.

Speeds: Planetary rpm 35-150; Spiral; Tool rpm ratio i=2,7.

Shipping information

Model	Net weight	Gross weight
AEROMIX 120	595kg (1311lb)	645kg (1421lb)
AEROMIX 160	610kg (1344lb)	660kg (1455lb)

Information on the packaging

MODEL	Box on pallet		Cage/Crate	
	Dimensions [mm]	Volume [m ³]	Dimensions [mm]	Volume [m ³]
AEROMIX 120	-	-	1380x1280x2380 (54"x50"x93")	4.20 (148.3ft ³)
AEROMIX 160	-	-	1380x1280x2380 (54"x50"x93")	4.20 (148.3ft ³)

